

Dowel  
Dowel

$\phi .750\text{in}$  Ref.  
[19.05mm]

Drilled & C'bored For  
"E" = 3/8" SHCS  
"M" = M10 SHCS  
(2) Places

2.480in Ref.  
[62.98mm]

.740in  $\pm .00$

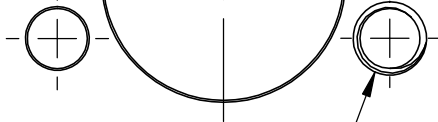

"E" = 3/8"-16 Tap  
"M" = M10-1.50 Tap  
(2) Places

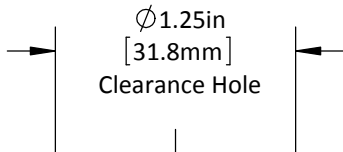

$\phi$  1.25in  
[31.8mm]  
Clearance Hole